

# CERTIFICATE OF LOCATION OF GOVERNMENT CORNER

\_\_\_\_\_ NORTHEAST \_\_\_\_\_ Corner of Section 36 , Township 105 , Range 39

\_\_\_\_\_ 5TH \_\_\_\_\_ Principal Meridian, State of Minnesota, County of MURRAY

At the corner location shown on the sketch:

- On \_\_\_\_\_ found a \_\_\_\_\_ CAST IRON MONUMENT WAS DESTROYED DURING CONSTRUCTION
- DATE
- left monument as found     lowered monument     removed monument (explain)
- On 5/15/2014 placed a 1/2" X 18" IRON PIPE WITH RLS CAP 44606
- DATE

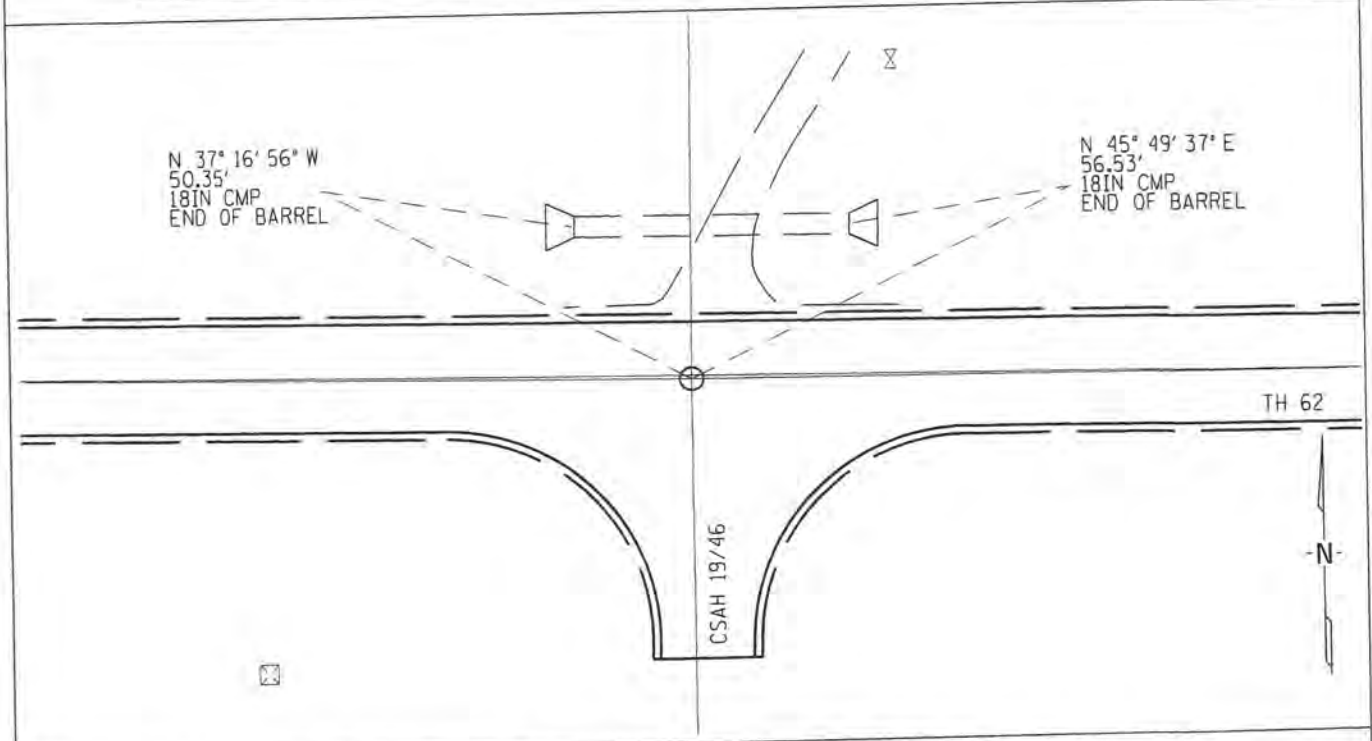

Statement of evidence for this corner location is on back of this page.

I hereby certify that this survey, plan, or report was prepared by me or under my direct supervision and that I am a duly Licensed Land Surveyor under the Laws of the State of Minnesota.

Signature \_\_\_\_\_ Date \_\_\_\_\_ License No. 44606

Title:     Land Surveyor     Professional Engineer     County Surveyor     County Engineer

**Statement of Evidence:** Northeast Corner of Section 36, Township 105 North, Range 39 West, 5<sup>th</sup> Principle Meridian, Murray County, Minnesota.

- 1861 This corner originally was set by D. W. Wellman and S. S. Smoot, Deputy Surveyors during the GLO survey which was completed in 1861.
- 1951 January 31, The Minnesota Department of Highways, n/k/a The Minnesota Department of Transportation (MN/DOT) Highway Right of Way Index Map No. 13-66 shows the corner being marked by an iron stake at P.I. Sta 400+51.6.
- 1956 M.H.D. set an aluminum cap in concrete monument over existing iron stake and measured new ties.
- 1974 July 31, an unsigned COL assumed to be from MN/DOT shows they found an aluminum disk in a concrete monument down 23" and left as found and placed a M.H.D. 20" cast iron monument over it.
- 1983 April 28, Bruce W. Sheppard, Land Surveyor Registration No. 17003 found a cast iron monument down 0.2' and left as found.
- 2011 In December, Sam DeLeo, LS 40341 of Kramer Leas DeLeo, P.C. found a cast iron monument at the location consistent with that described above. Coordinate values were established on the monument using RTK/GPS methods as follows:  
Northing 105695.37  
Easting 356023.63  
Murray County Coordinates.  
NAD83 (2007 HARN Adj.)
- 2014 On May 15th, 2014, Kyle Klasen, LS 44606 of WSB and Associates set a ½" x 18" iron pipe capped with 44606 after the re-construction of TH 62. The coordinate value of the Corner was obtained from MnDOT, District 7 survey department and established by Mr. DeLeo in December, 2011.